

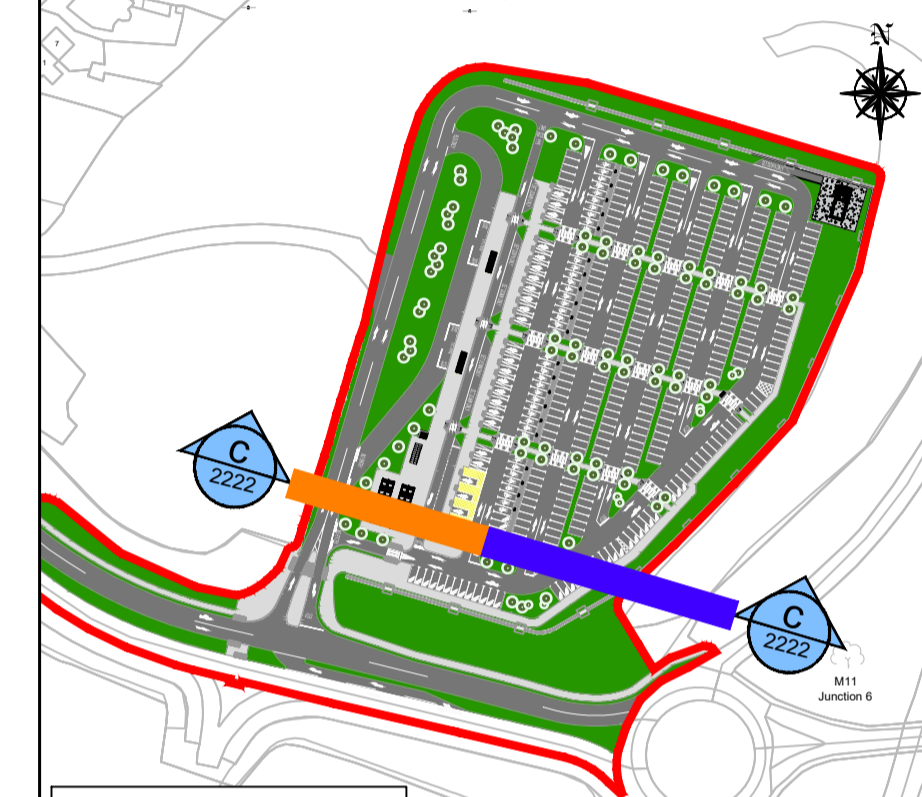

Tionscaldal Éireann
Project Ireland
2040

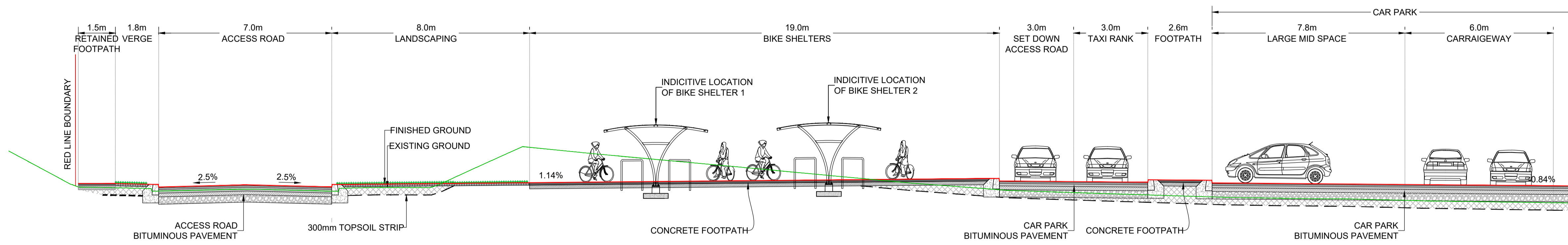

SECTION PLAN
NOT TO SCALE



VIEWPORT 1

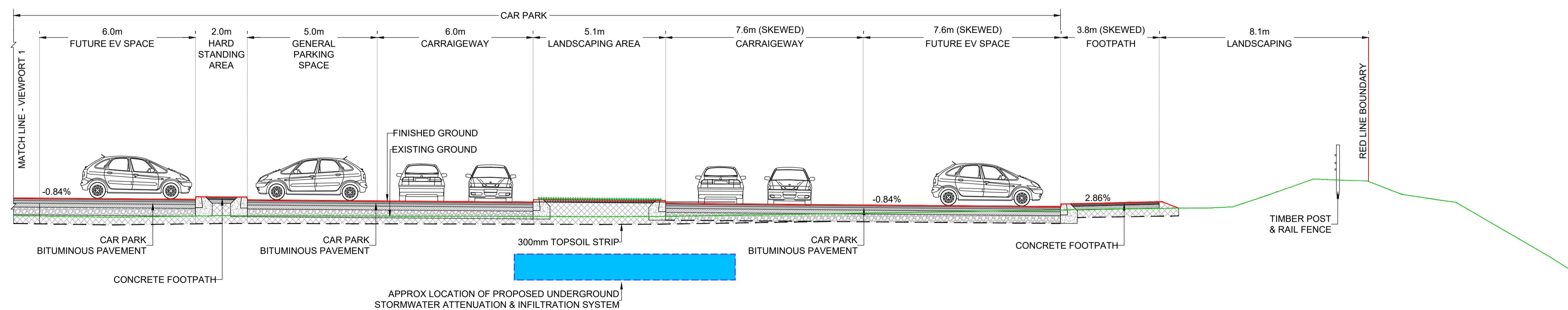

VIEWPORT 2

P03	ISSUED FOR PLANNING	SM	BD	28/07/23
Rev	Description	Drawn	Checked	Date

Clifton Scannell Emerson Associates
 Clifton Scannell Emerson Associates Limited
 Consulting Engineers,
 3rd Floor The Highline,
 Bakers Point, Pottery Road,
 Dun Laoghaire, Co. Dublin,
 Ireland, A96 KW29
 T: +353 1 288 5006
 F: +353 1 283 3466
 E: info@csea.ie
 W: www.csea.ie

Client: WICKLOW COUNTY COUNCIL
 Project: FASSAROE PARK AND RIDE FACILITY
 Dwg. Title: TYPICAL CROSS SECTION SECTION C-C

Drawn By: SM Date: JULY 2023
 Checked By: BD Scale: N.T.S@ A1
 Project Code: 20_008N - CSE - GEN - XX - DR - C - 2222

Status Code: S2 Part VIII Approval
 Project Status: P03 FOR PLANNING